

MICRON CHUCK M series

FEATURES P. 1-6

SK (No) -HPC (D) M-L

▶▶ Thru-the-tool Coolant Available

M-series

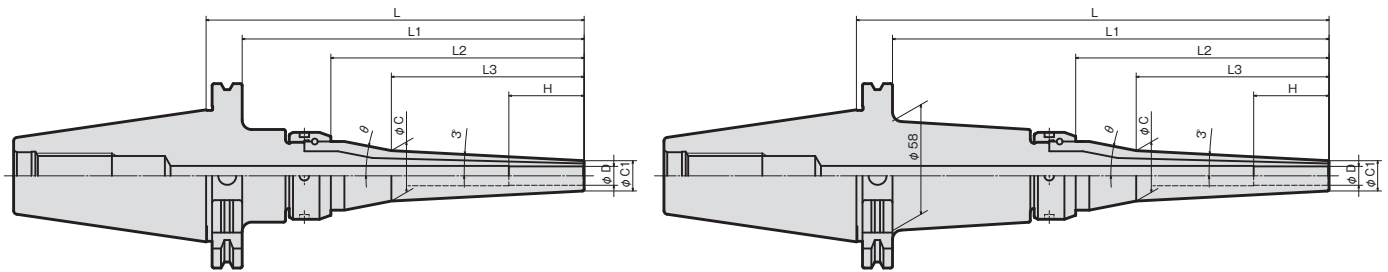

Cutter shank diameter should be h6 or better.

MODEL	STOCK	FIG	φD	φC1	φC2	L	L1	L2	L3	H	MINI.INS. LENGTH	ADJUST LENGTH		M	°	N/W(kg)			
												MIN	MAX						
SK40	HPC03M-145	△	3	9	16	145	108	84	67	18	20	-	-	-	34	1.4			
	HPC03M-195	△			20	195	158	134	102						18	1.6			
	HPC04M-145	△	4	10	17	145	108	84	67	20					-	-	-	33	1.4
	HPC04M-195	△			21	195	158	134	102									17	1.6
	HPC06M-145	△	6	12	19	145	108	84	67	36	35	35	49	M6				30	1.5
	HPC06M-195	△			23	195	158	134	102									15	1.6
	HPC08M-145	△	8	13	21	145	108	84	67	50				35	49	M8	27	1.5	
	HPC08M-195	△			25	195	158	134	102								13	1.7	
	HPC10M-145	△	10	14	23	145	108	84	67	50	35	49	M8				24	1.5	
	HPC10M-195	△			27	195	158	134	102								11	1.7	
	HPC12M-145	△	12	16	25	145	108	84	67	55				40	54	M10	21	1.5	
	HPC12M-195	△			29	195	158	134	102								9	1.7	
SK50	HPC03M-150	△	3	9	16	150	112	84	67	18	20	-	-				-	34	4.2
	HPC03M-200	△			20	200	162	134	102									18	4.4
	HPC03M-250	△	2	250	212	134	102	18	5.3										
	HPC04M-150	△	4	10	17	150	122	84	67	20				-	-	-		33	4.3
	HPC04M-200	△			21	200	162	134	102		17	4.4							
	HPC04M-250	△	2	250	212	134	102	17	5.3										
	HPC06M-150	△	6	12	19	150	122	84	67	36	35	49	M6				30	4.3	
	HPC06M-200	△			23	200	162	134	102					15	4.5				
	HPC06M-250	△	2	250	212	134	102	15	5.3										
	HPC08M-150	△	8	14	21	150	122	84	67	50				35	49	M6	27	4.3	
	HPC08M-200	△			25	200	162	134	102		13	4.5							
	HPC08M-250	△	2	250	212	134	102	13	5.4										
	HPC10M-150	△	10	16	23	150	122	84	67	50	35	49	M8				24	4.3	
	HPC10M-200	△			27	200	162	134	102					11	4.5				
	HPC10M-250	△	2	250	212	134	102	11	5.4										
	HPC12M-150	△	12	18	25	150	122	84	67	55				40	54	M10	21	4.3	
	HPC12M-200	△			29	200	162	134	102		9	4.5							
	HPC12M-250	△	2	250	212	134	102	9	5.4										

BT series

HSK series

ST series

Versatile Tool

Cutting Tool

Accessories



ACCESSORIES

▶ P.42 STRAIGHT COLLETS



ACCESSORIES

▶ P.44 ADJUST SCREW, CHUCK WRENCH

ORDERING EXAMPLE

① SK50 - ② HPC ③ 03 ④ M - ⑤ 130

- ① Shank Size
- ② Holder's Name
- ③ Cutter's Shank Dia.
- ④ M series
- ⑤ G.L.Length

ACCESSORIES for MICRON CHUCK H series M series



ADJUST SCREW for MICRON CHUCK H series, M series

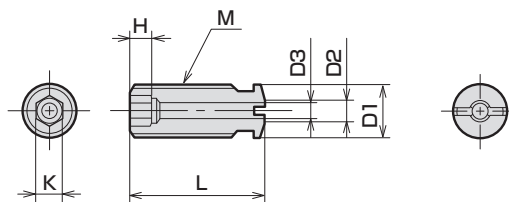

MODEL	CODE	M	L	D1	D2	D3	K	H	MICRON CHUCK
AS17-2-M5-CTW	17672	M5×0.8	17	5	3	2	2.5	3	HPC06H
AS17-2-M6-CTW	17676	M6×1.0	17	6			HPC07H		
AS22-2-M6-CTW	17678		22	8	5	4	HPC08H,HPC08M		
AS22-2-M8-CTW	17680	M8×1.25	25	8	5	4	4	5	HPC09H,HPC10H HPC09M,HPC10M,HPC11M~12M
AS25-2-M8-CTW	17682			10	6	5	5	6	HPC11H~16H
AS25-2-M10-CTW	17684	M10×1.5							

ACCESSORIES for MICRON CHUCK H series M series



CHUCK WRENCH (For MICRON CHUCK H series, M series and N series)

HOOK PIN SPANNER		
CHUCK CODE	WRENCH CODE	
MICRON CHUCK		
HPC03H~HPC16H HPC03M~HPC12M HPC03N~HPC12N	FP45-48G	35851