

# Point Finder with Buzzer

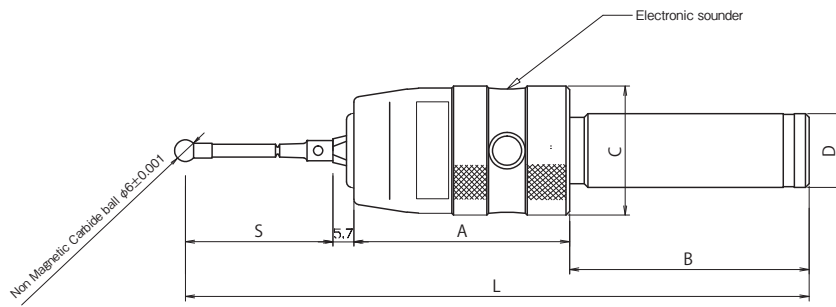

MODEL	CODE	D	S	A	B	L	C	Mass (g)	Battery (included)
PTC-20	83662	φ20	40	58.6	65	169.3	35	350	Manganese battery R1 (UM-5) X2
PTC-32	83664	φ32	40	58.6	65	169.3	35	600	

Contact pressure of the stylus and workpiece is small, the LED lights at 0.1 gf. Measure accurately even on thin workpieces. If "with buzzer", we will inform the position detection simultaneously with the electronic sound and the LED.

Also, the safety that the stylus swings in X, Y, Z direction design. With the development of the new mechanism (patent pending), the measurement accuracy of metal and nonferrous metals has dramatically improved.

Stylus stroke / XY axis	±13mm
Stylus stroke / Z axis	±5mm
Buzzer frequency	2,700Hz
Measuring pressure	0.1gf
Repeatability	±0.5μm
Standard stylus (with φ 6 x 40 mm)	