

FEATURES

- Versatile modular type boring system.
- Rigidity is increased by the new coupling method and the serrated head.
- Twin blades allow heavy cutting.
- Extensions are used for deep holes.

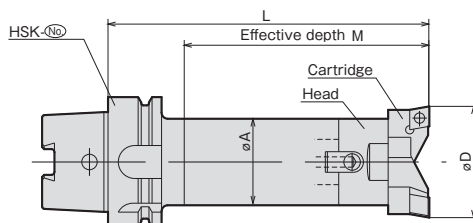

RANGE (D)	MODEL	CODE	SHANK	HEAD	CARTRIDGE	L	M	L ₁	øA	N/W (kg)	
ø25~33	HSKA63	- TWC 25 - 120 - S	HSKA63	- SBS1 - 120	HE25	CT25	120	85	83	24	1.2
ø32~45		- TWC 32 - 135 - S		- SBS2 - 135	HE32	CT32	135	100	98	31	1.5
ø44~63		- TWC 44 - 135 - S		- SBS3 - 135	HE44	CT44	135	100	91	42	2.0
ø62~89		- TWC 62 - 135 - S		- SBS4 - 135	HE62	CT62	135	100	82	54	3.0
ø88~126	HSKA100	- TWC 88 - 165 - S	HSKA100	- SBS5 - 165	HE88	CT88	165	130	100	64	5.7
ø25~33		- TWC 25 - 150 - S		- SBS1 - 150	HE25	CT25	150	104	113	24	2.6
ø32~45		- TWC 32 - 165 - S		- SBS2 - 165	HE32	CT32	165	119	128	31	3.0
ø44~63		- TWC 44 - 165 - S		- SBS3 - 165	HE44	CT44	165	119	121	42	3.6
		- TWC 44 - 225 - S		- SBS3 - 225			225	179	181		4.2
ø62~89		- TWC 62 - 165 - S		- SBS4 - 165	HE62	CT62	165	119	112	54	4.7
		- TWC 62 - 240 - S		- SBS4 - 240			240	194	187		5.9
		- TWC 62 - 285 - S		- SBS4 - 285			285	239	232		6.7
ø88~126		- TWC 88 - 165 - S		- SBS5 - 165	HE88	CT88	165	119	100	64	6.0
		- TWC 88 - 240 - S		- SBS5 - 240			240	194	175		7.8
		- TWC 88 - 330 - S		- SBS5 - 330			330	284	265		10.0
ø125~175		- TWC125 - 185 - S		- SBS6 - 185	HE125	CT125	185	139	113	82	8.8
	- TWC125 - 240 - S	- SBS6 - 240	240	194			168	9.6			
	- TWC125 - 330 - S	- SBS6 - 330	330	284			258	14.8			

- NOTE : 1. Coolant pipe is included.
 2. Inserts are sold separately.
 3. Inserts are in phase with the drive key.
 4. Thru-the tool coolant type if manufactured by order.

ORDERING EXAMPLE

①	②	③	④	⑤
HSKA63	TWC	25	120	S
① Shank Size				
② Name				
③ Min. øD				
④ G.L. Length				
⑤ Set				



ACCESSORIES

➔ P.133 INSERTS



ACCESSORIES

➔ P.137 EXTENSION · REDUCTION

FEATURES

For high stock removal with balanced blade, for $\phi 175 \sim \phi 375$ mm bores.

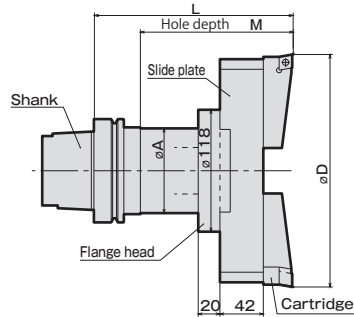

HSK series

RANGE(D)	MODEL	CODE	SHANK	FLANGE HEAD	SLIDE PLATE	CARTRIDGE	INSERT	L	M	φA	N/W (kg)	
φ175~225	- TWC175 - 205 - S	350185	HSKA100	- SBS6 - 185	TWC - FH - 0 (TWC - FH - 90)	SP175 - 42	CT125	WT62-127	205	159	82	12.2
	- TWC175 - 260 - S	350186		- SBS6 - 240					260	214		14.5
	- TWC175 - 350 - S	350187		- SBS6 - 330					350	304		17.9
φ225~275	- TWC225 - 205 - S	350188	HSKA100	- SBS6 - 185	TWC - FH - 0 (TWC - FH - 90)	SP225 - 42	CT125	WT62-127	205	159	82	13.6
	- TWC225 - 260 - S	350189		- SBS6 - 240					260	214		15.9
	- TWC225 - 350 - S	350190		- SBS6 - 330					350	304		19.4
φ275~325	- TWC275 - 205 - S	350191	HSKA100	- SBS6 - 185	TWC - FH - 0 (TWC - FH - 90)	SP275 - 42	CT125	WT62-127	205	159	82	16.1
	- TWC275 - 260 - S	350192		- SBS6 - 240					260	214		18.3
	- TWC275 - 350 - S	350193		- SBS6 - 330					350	304		21.8
φ325~375	- TWC325 - 205 - S	350194	HSKA100	- SBS6 - 185	TWC - FH - 0 (TWC - FH - 90)	SP325 - 42	CT125	WT62-127	205	159	82	17.3
	- TWC325 - 260 - S	350195		- SBS6 - 240					260	214		19.6
	- TWC325 - 350 - S	350196		- SBS6 - 330					350	304		23.1

- NOTE : 1. Coolant pipe is included.
 2. Inserts are sold separately.
 3. Inserts are in phase with the drive key.
 4. TWC-FH-90 Flange Head is used to change the phase to 90°.

ORDERING EXAMPLE

①	②	③	④	⑤
HSKA100	-	TWC 175	-	185 - S
① Shank Size	② Name	③ Min. φD	④ G.L. Length	⑤ Set

ACCESSORIES for <BORING SYSTEM> TWINCUT Double-Face-Contact Shank



INSERT for TWINCUT



TWINCUT	CODE				ISO CODE	I. C.	T	R	CARTRIDGE	SCREW	DRIVER
	STEEL	CAST IRON									
	WT25 - 079P	32901	WT25 - 079K	32911	CC**080304	7.94	3.18	0.4	CT25	BFTX0307	TRX10
	WT32 - 095P	32902	WT32 - 095K	32912	CC**090308	9.525			CT32~44	BFTX0409N	TX215
	WT62 - 127P	32903	WT62 - 127K	32913	CC**120408	12.7	4.76	0.8	CT62~125	BFTX0511N	TRX220

NOTE : 1. Inserts are available in 10 pcs boxes.



EXTENSION



For deeper holes.

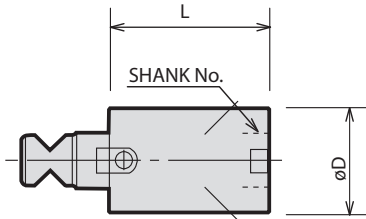

MODEL	CODE	SHANK No.	øD	L
TEX1 - 40	32610	1	24	40
TEX2 - 45	32620	2	31	45
TEX3 - 50	32630	3	42	50
TEX3 - 65	32631			65
TEX4 - 65	32640	4	54	65
TEX4 - 90	32641			90
TEX5 - 75	32650	5	64	75
TEX5 - 105	32651			105
TEX6 - 75	32660	6	82	75
TEX6 - 105	32661			105

ORDERING EXAMPLE

① **TEX** ② **1** - ③ **40**

- ① Name
- ② Shank No.
- ③ L



REDUCTION



For using smaller heads.

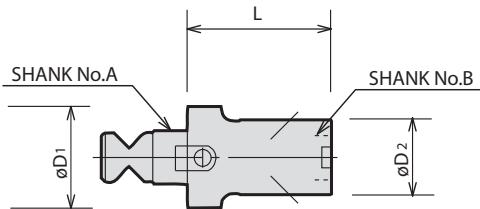

MODEL	CODE	SHANK No.A	SHANK No.B	øD1	øD2	L
RE2X1 - 60	32720	2	1	31	24	60
RE2X1 - 90	32721					90
RE3X1 - 60	32730	3	2	42	31	60
RE3X1 - 90	32731					90
RE3X2 - 60	32735	4	1	54	24	60
RE3X2 - 90	32736					90
RE4X1 - 60	32740	5	3	64	31	60
RE4X1 - 90	32741					90
RE4X2 - 60	32743	6	4	82	42	60
RE4X2 - 90	32744					90
RE4X3 - 60	32746	3	2	54	31	60
RE4X3 - 90	32747					90
RE5X2 - 60	32750	4	3	64	42	60
RE5X2 - 105	32751					105
RE5X3 - 60	32753	5	4	82	54	60
RE5X3 - 105	32754					105
RE5X4 - 60	32756	6	5	82	64	60
RE5X4 - 105	32757					105
RE6X3 - 75	32760	3	2	54	31	75
RE6X3 - 90	32761					90
RE6X4 - 75	32763	4	3	64	42	75
RE6X4 - 90	32764					90
RE6X5 - 75	32766	5	4	82	54	75

ORDERING EXAMPLE

① **RE** ② **2×1** - ③ **60**

- ① Name
- ② Shank No. A×B
- ③ L